



# GALVANISED SPEED BRACE

JUL23

Compliant with the requirements of AS1684 and AS4440.

**G GALVANISED**

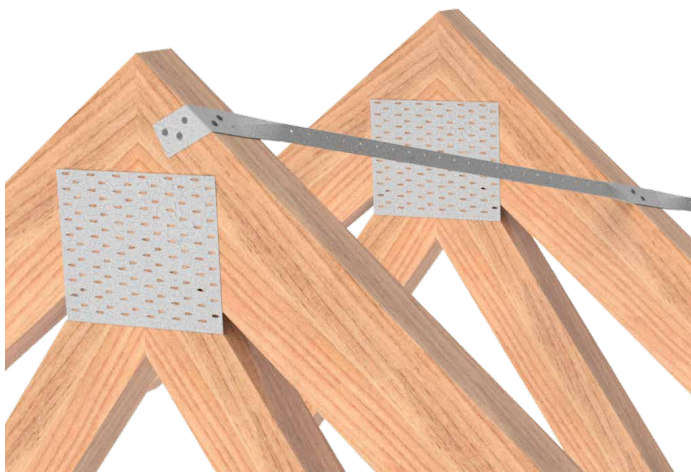
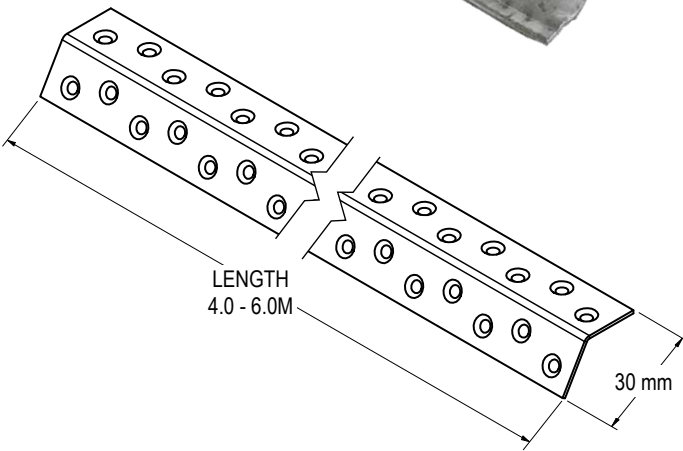
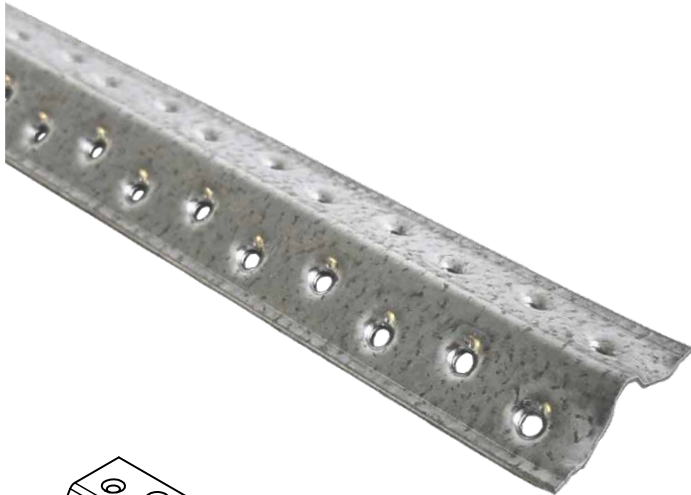

## APPLICATION

VUETRADE Speed Brace are a pre-punched, rigid bracing used for top chord roof bracing. Manufactured and pre-formed angle for easy installation and guarantees excellent tension capacity.

Pre-punched for quick and easy installation, VUETRADE Speed Brace provides solution for resisting buckling in the trusses, as well as from the wind uplift.

## SPECIFICATION

VUETRADE Speed Brace are manufactured using G300 Z275 galvanized steel as per AS4440-2004 requirements. VUETRADE Speed Brace has a total thickness of 1.0mm.

## FASTENERS

**Nails:** Use only VUETRADE 30mm x 2.8mm Ø Galvanised Connector Plate Nails

Detailed installation illustration is given in the following section of this document. AS4440-2004 shall be read in conjunction with this document for further fixing details and installation guide.

## PRODUCT SIZES

Product Code	Size (m)	Pack Quantity
SPEED410	4.0	10
SPEED510	5.0	10
SPEED610	6.0	10

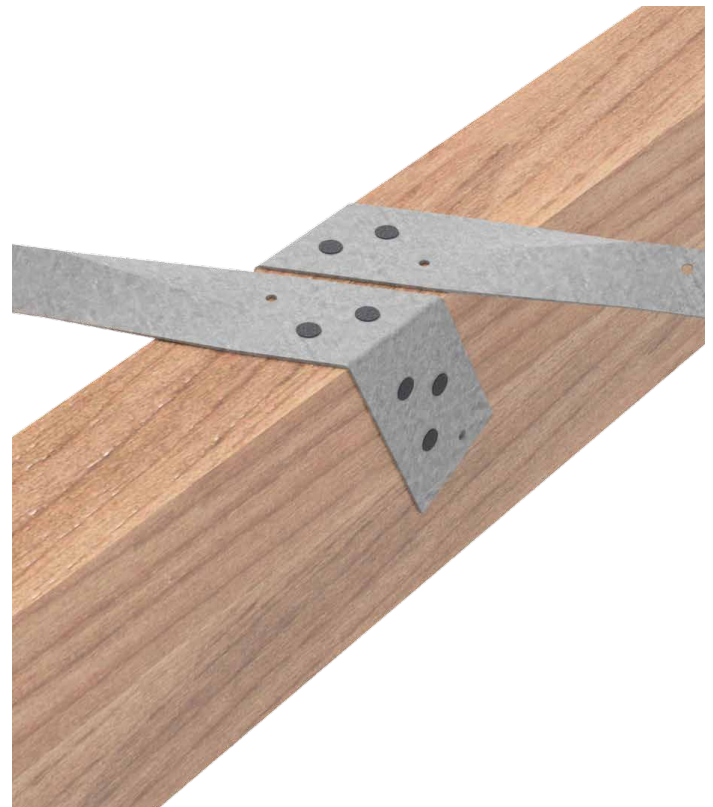



**GALVANISED SPEED BRACE**

JUL23

**INSTALLATION AND NAILING SCHEDULE (ROOF BRACING)**

Install VUETRADE Speed Brace following the installation methods detailed below, further installation guides and fixing details shall refer to the Australian Standard AS4440-2004 - *Installation of nailplated timber roof trusses*.

**END FIXING AT APEX INSTALLATION**

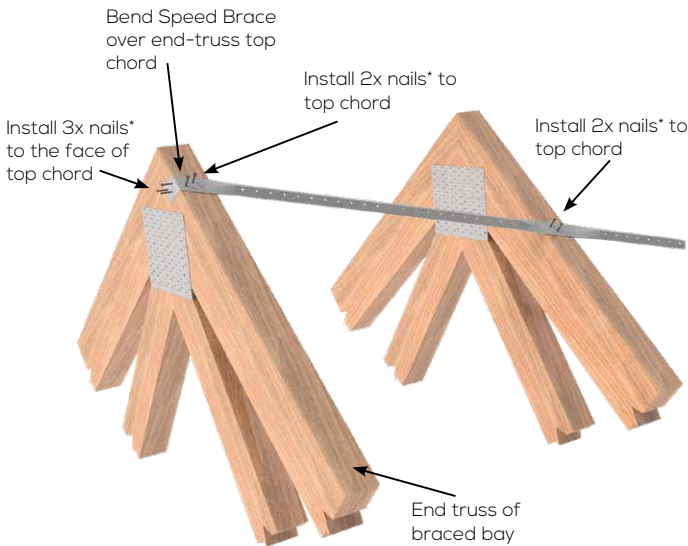

**SPEED BRACE SPLICING INSTALLATION**

**LAP SPLICE**

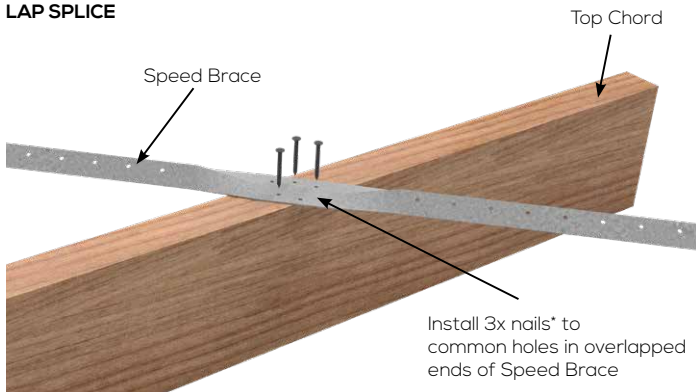

**WRAP AROUND SPLICE**

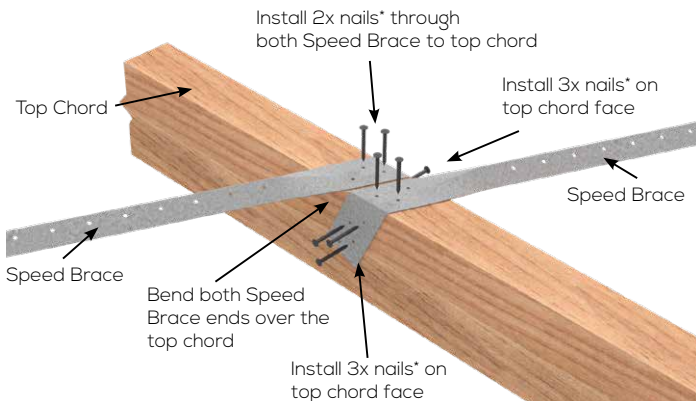

**END FIXING DETAILS AT HEEL TO TOP PLATE**

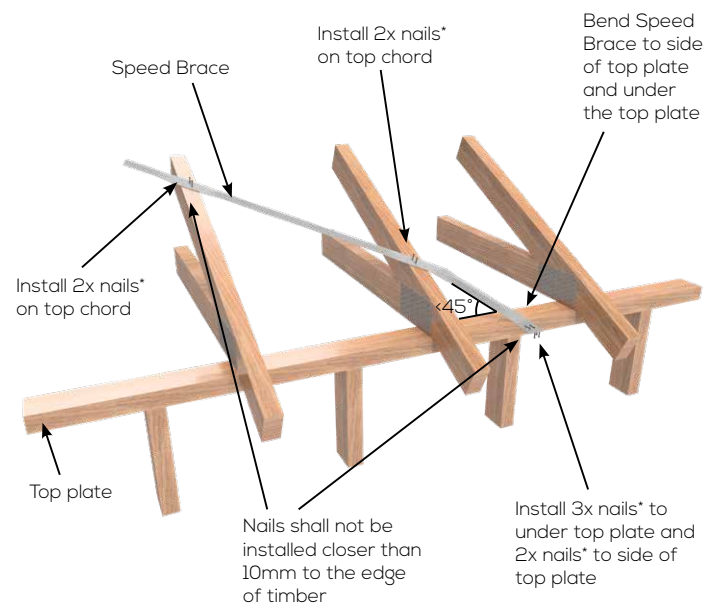

\* Use only VUETRADE 30mm x 2.8mm Ø Galvanised Connector Plate Nails.

**DESIGN CAPACITIES**

VUETRADE Speed Brace has been tested to meet the tension capacity requirements outlined in AS4440-2004 - *Installation of nailplated timber roof trusses* for steelbrace, with design capacity shown in Table 1.

Table 1: Design capacity of VUETRADE Speed Brace

Product	Product Size	Design Capacity, kN
VUETRADE Speed Brace	34mm x 1.0mm thickness	9.63 kN

**NOTES:**

1. Design Capacity obtained in Table 1 is obtained via test and computed by VUETRADE following requirements outlined in relevant Australian Standards.
2. To achieve tabulated design capacity, VUETRADE Speed Brace must be installed in accordance to the installation methods listed in this document or to specifications listed in AS4440-2004.
3. Use only VUETRADE 30mm x 2.8mm Ø Galvanised Connector Plate Nails to fasten Speed Brace to roof truss / top chord to achieve design capacity.

